

Exchange ActiveSync for Android

From the Android Menu, go to **Settings** and choose **Accounts & Sync**. Select the **Add Account** icon.

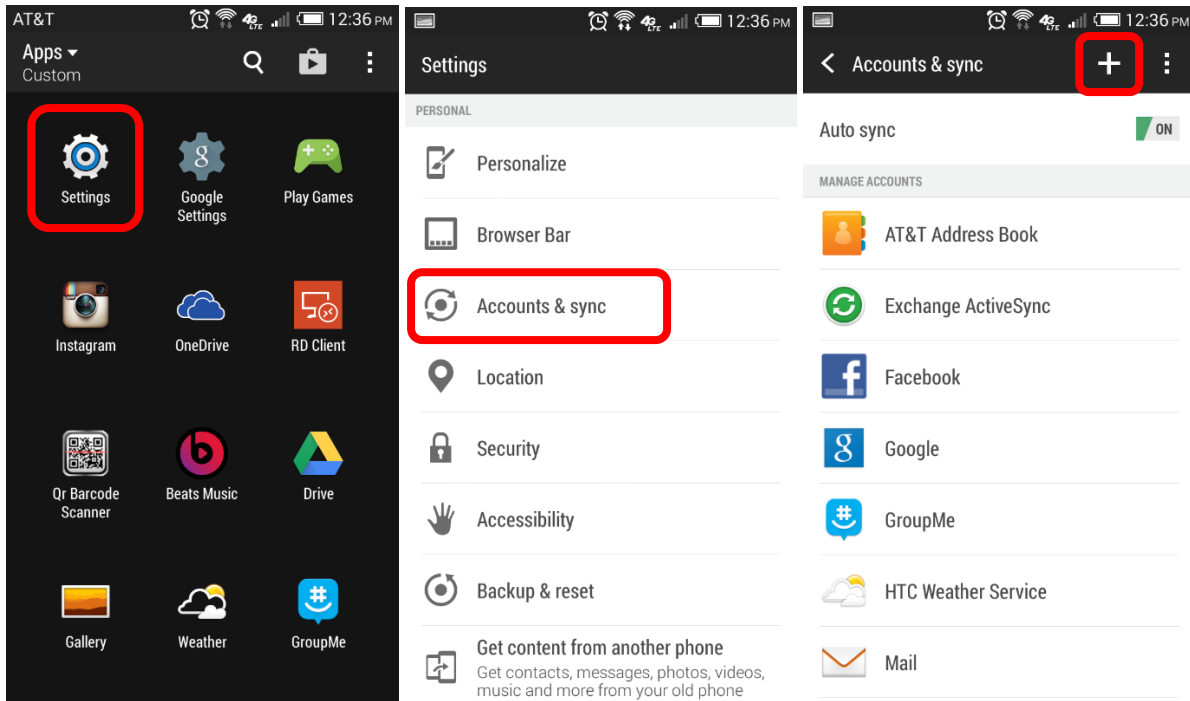

Then select **Exchange ActiveSync**.

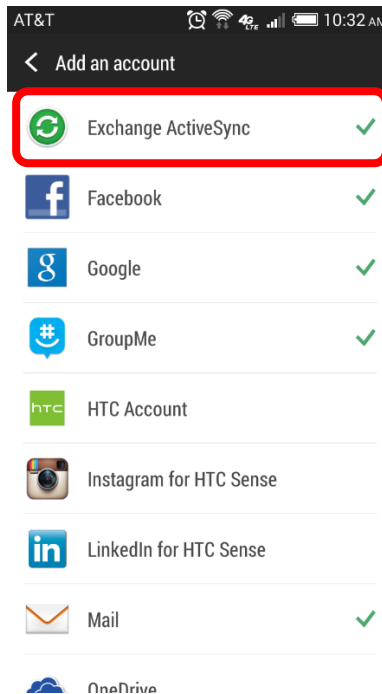

While setting up your Exchange ActiveSync account, make sure to input the following information:

Email Address: **YourNID@ucf.edu**

Server Address: **webmail.ucf.edu**

Domain: **NET**

Username: **Your NID**

Password: **Your NID Password**

Then customize your account settings, and give a name to your account. Then **Finish Setup**.

The image displays three sequential screenshots of the Exchange ActiveSync account setup process on an Android device. The first screenshot, titled "Set up Exchange ActiveSync account", shows the input fields for the account information: Email Address (NID@ucf.edu), Server Address (webmail.ucf.edu), Domain (NET), Username (NID), and Password (masked with dots). A checkbox for "This server requires an encrypted SSL connection" is checked. The "NEXT" button is highlighted with a red box. The second screenshot, titled "Exchange ActiveSync settings", shows the selection of data to synchronize: Mail, Contacts, Calendar, and Tasks, all of which are checked. There are also options for "Smart Sync" and "Push mail", both of which are unchecked. The "NEXT" button is highlighted with a red box. The third screenshot, titled "Add account", shows the account name "Test Knight" and a checkbox for "Make this my default mail account" which is unchecked. The "FINISH SETUP" button is highlighted with a red box.

The next two screens will be security prompts. Select **OK** and **Activate**, and your Exchange ActiveSync account will be all set.

